

Wiper control

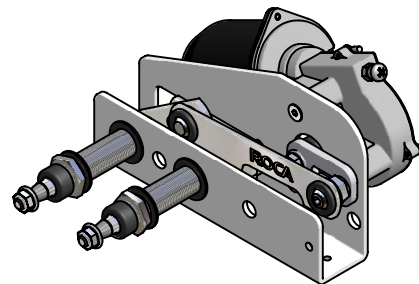

SWIB

Wiper motors



W38	
531011/21/31	12V
531012/22/32	24V

Item no.	Voltage
532043	12 / 24 V

3 motors
 Helm seat motor, 2 or 3 motors
 Synchronized sweep
 Interval
 Slow speed
 Fast speed
 Washer output

Function for switch

- One push to the on position will start 3 motors in synchronized interval.
- One more push to momentary will run 3 motors slow speed synchronized.
- One more push will run 3 motors fast speed synchronized.
- One more push starts from interval and so on.
- One long push from off to momentary will start 1 motor in interval (wiper 1).
- One more push will run 1 motor slow speed.
- One more push will run 1 motor fast speed.
- One more push starts 1 motor from interval and so on.

Washer:

When running, push switch to momentary more than one second and washer will start.

If the wiper motors gets overloaded the power automatically breaks.

Push switch to off, then to on and motor will start again.

