

東莞正揚電子機械
有限公司
機密文件

KEY PRODUCT CHARACTERISTICS		ISSUE	DATE	ZONE	REVISION HISTORY	DRAW
1.	Indicates special characteristics related to safety;					
2.	Indicates special characteristics related to customer interface;					
3.	Indicates critical characteristics defined by ZEM.					
4.	Please see the list for Customer Special Characteristics.					

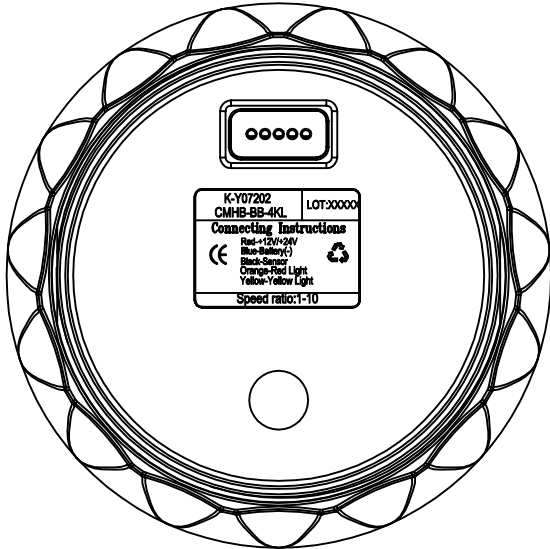

K-Y07202
CMHB-BB-4KL LOT:30000
Connecting Instructions
Red +12V(+24V Blue Battery)
Black Sensor
Orange-Red Light
Yellow-Yellow Light
Speed ratio:1-10

Test Data	scale(rpm)	1000	2000	3000	4000
	signal input(Hz)	250	500	750	1000

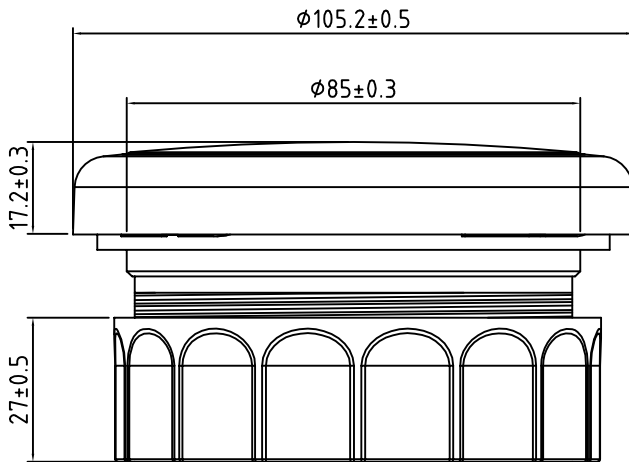

KUS 正揚電子機械有限公司 ZHENG YANG ELECTRONIC MECHANICAL LTD. All information contained in this document are to be treated as trade secret and confidential to KUS. The copying, distribution and utilization of this document for any purpose without written consent of KUS is prohibited. Any infringement will be legally pursued.	MATERIAL:		COLOUR:	PROJECT:	
				Speed Gauge	
	ENGINEERED	09. 10. 30	Smaky		PART NAME:
	CHECKED				CMHB-BB-4KL
	APPROVED				DRAWING NO:
FIRST ANGLE PROJECTION				ISSUE:	
TOLERANCE CLASS FROM 0.5 UP TO 3 OVER 3 UP TO 6 OVER 6 UP TO 30 OVER 30 UP TO 120 OVER 120 UP TO 400 OVER 400 UP TO 5000 ISO 2768 m ±0.1 ±0.1 ±0.2 ±0.3 ±0.5 ±0.8				CUSTOMER NO:	
SCALE: 1:1		SIZE: A4	UNIT: mm	SHEET NO: 1 OF 1	