

INSTALLATION INSTRUCTIONS

INSULCAP (Heat Shrinkable End-caps)

General Instructions:

The end-caps supplied by us are in an expanded form. When heated above 125°C they attempt to shrink back to their original dimensions, conforming to the objects they cover. Use a propane (preferred) or butane gas torch. Adjust the torch to obtain a soft blue flame with a yellow tip. Pencil-like blue flames should be avoided. Keep the torch aimed in the shrink direction to preheat the material. Keep the flame moving continuously to avoid scorching the material.

Cable Preparation:

If necessary cut the cable end so that it is straight and even. Remove serving and armour (if any). Clean and de-grease cable and parts that will come into contact with sealant. (Fig. 1)

Installation of cable cap:

Place the cap over the end of the cable. (Fig. 2)

Shrink the cap into place, starting at the closed end and working towards the cable. Adhesive will be visible at ends. (Fig. 3)

Properly installed cap will be smooth and conform to cables. Allow the cap to cool before applying any mechanical strain. Installation of cable cap completed. (Fig. 4)

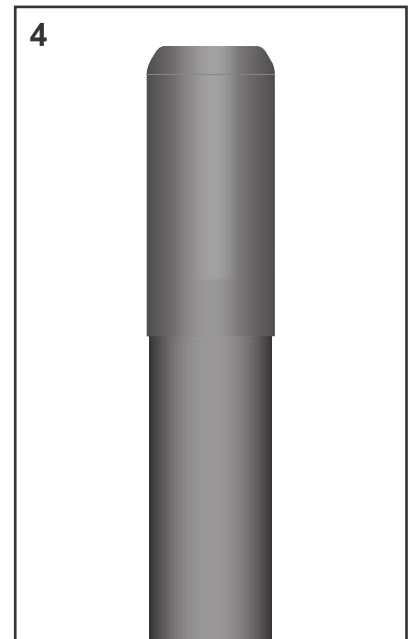
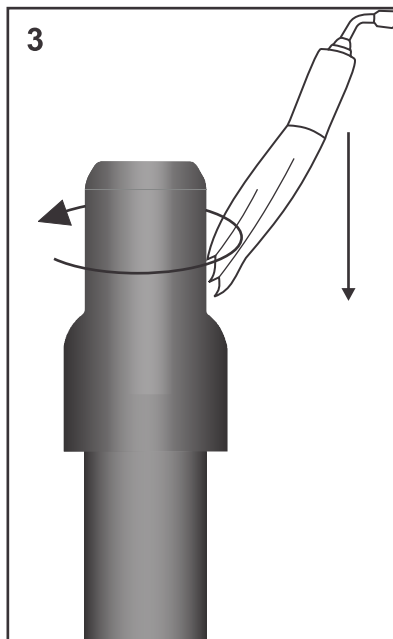
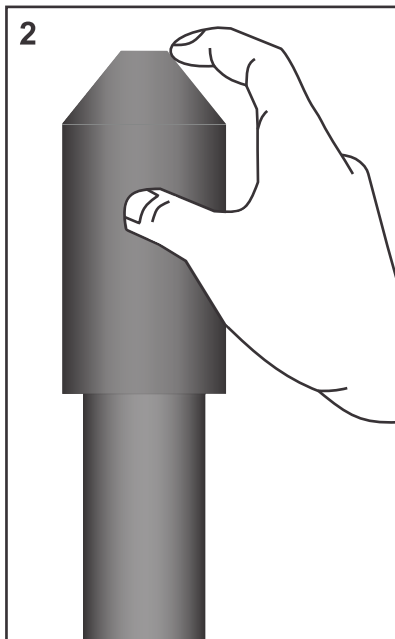
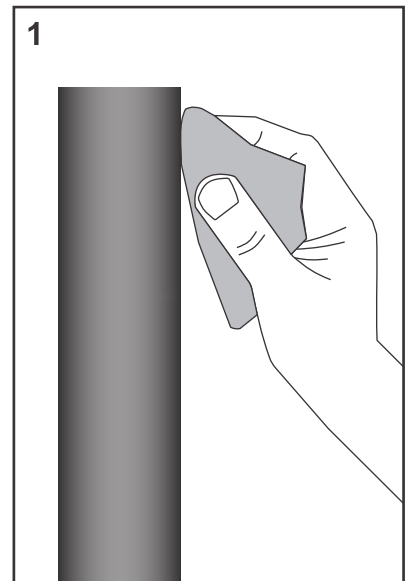

The information contained in these installation instructions is for use only by installers trained to make electrical power installations and is intended to describe the correct method of installation for this product. However, we have no control over the field conditions which influence product installation. It is the user's responsibility to determine the suitability of the installation method in the user's field conditions. Our only obligations are those in our standard Conditions of Sale for this product and in no case will we be liable for any other incidental, indirect or consequential damages arising from the use or misuse of the products.

INSTALLATION INSTRUCTIONS

INSULCAP (Heat Shrinkable End-caps)

General Instructions:

The end-caps supplied by us are in an expanded form. When heated above 125°C they attempt to shrink back to their original dimensions, conforming to the objects they cover. Use a propane (preferred) or butane gas torch. Adjust the torch to obtain a soft blue flame with a yellow tip. Pencil-like blue flames should be avoided.

Keep the torch aimed in the shrink direction to preheat the material. Keep the flame moving continuously to avoid scorching the material.

Cable Preparation:

If necessary cut the cable end so that it is straight and even. Remove serving and armour (if any). Clean and de-grease cable and parts that will come into contact with sealant. (Fig. 1)

Installation of cable cap:

Place the cap over the end of the cable. (Fig. 2)

Shrink the cap into place, starting at the closed end and working towards the cable. Installation of cable cap completed. (Fig. 3)

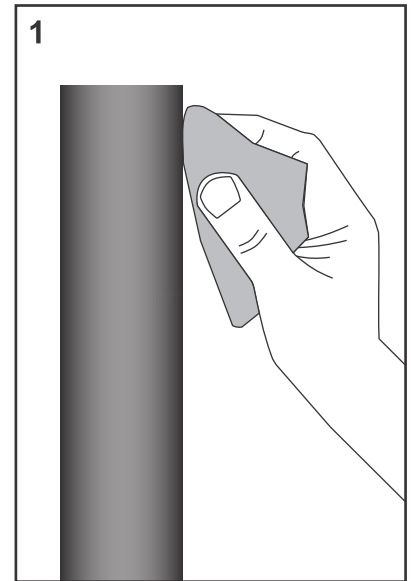

Allow the cap to cool before applying any mechanical strain. (Fig. 4)

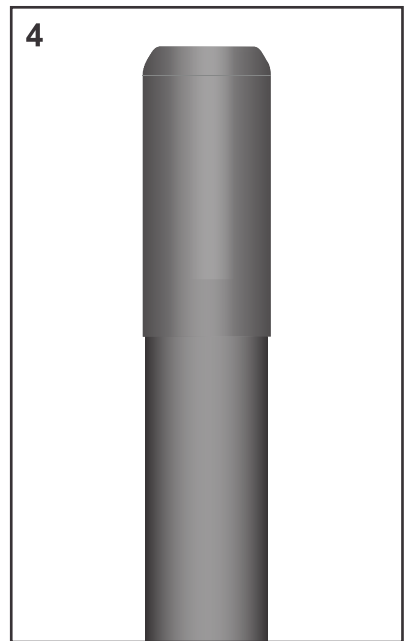
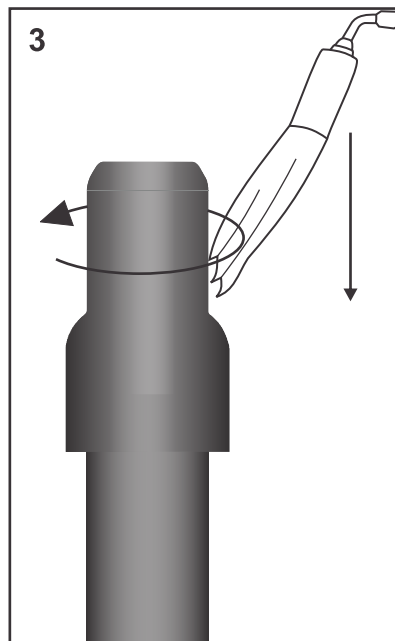
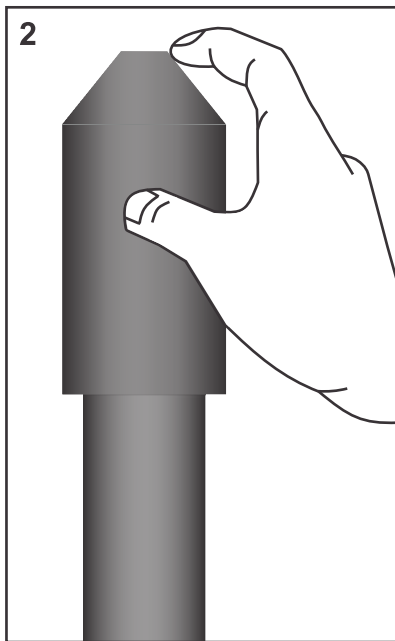

The information contained in these installation instructions is for use only by installers trained to make electrical power installations and is intended to describe the correct method of installation for this product. However, we have no control over the field conditions which influence product installation. It is the user's responsibility to determine the suitability of the installation method in the user's field conditions. Our only obligations are those in our standard Conditions of Sale for this product and in no case will we be liable for any other incidental, indirect or consequential damages arising from the use or misuse of the products.