

PROPELLER SHAFT SEALING KIT - STUFFY BOX EVOLUTION

STUFFY BOX EVOLUTION HAS GOT A BARBED WATER PIPE WHICH ALLOWS FOR A COMPLETE WATER LUBRICATION. STUFFY BOX EVOLUTION HAS GOT A GREASING NIPPLE FOR A PERFECT LUBRICATION WITH THE STUFFY GREASE. STUFFY BOX EVOLUTION CAN BE INSTALLED BOTH ABOVE AND BELOW THE WATERLINE. BEFORE INSTALLING STUFFY BOX EVOLUTION PLEASE PAY ATTENTION THAT THE WATER PIPE AND THE WATER INLETS OF THE STERN TUBE MUST BE FREE. THE MINIMUM LENGTH OF THE PART OF STERN TUBE WHERE THE STUFFY BOX WILL BE PLACED, MUST BE AT LEAST 40 MM. PLEASE NOTE THAT STUFFY BOX EVOLUTION MUST BE MOUNTED INSIDE THE BOAT, WHILE AN EXTERNAL SHAFT'S STRUT OR A WATER LUBRICATED STERN BOX MUST BE MOUNTED ON THE OUTSIDE.

MOUNTING

1. MAKE SURE THAT THE PART OF THE SHAFT ROTATING INSIDE THE STUFFY BOX EVOLUTION PROVIDES NEITHER BURRS NOR SCRATCHES.
2. IF THERE ARE BURRS OR IMPERFECTIONS ON THE SHAFT'S END, THE STUFFY BOX EVOLUTION LIPS MAY GET DAMAGED DURING INSTALLATION.
3. THE PART OF THE TUBING WHERE THE STUFFY BOX EVOLUTION WILL BE MOUNTED MUST BE CAREFULLY CLEANED. (THE SURFACE NEEDS TO BE ABSOLUTELY GREASE FREE).
4. PRESS THE STUFFY BOX EVOLUTION ONTO THE PROPELLER SHAFT, FIX IT TO THE STERN TUBE AND THEN TIGHTEN THE CLAMP.
5. CONNECT THE PROPELLER SHAFT TO THE ENGINE AND MAKE SURE THAT IT IS PROPERLY CENTRED INTO THE STERN TUBE.
6. REMOVE THE PROTECTIVE SLEEVE FROM THE PROPELLER SHAFT BY SPLITTING IT, OTHERWISE WHEN LAUNCHED THE BOAT MAY GET FILLED WITH WATER.
7. UNSCREW THE GREASING NIPPLE CAP, PUT THE STUFFY GREASE LUBRICANT INTO THE HOLE, THEN TIGHT THE CAP BACK.

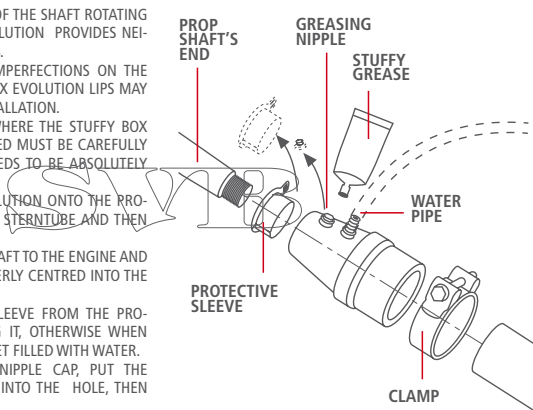

NOTE:

1. THE STUFFY GREASE TUBE INCLUDED IN THE KIT MAY BE OF USE FOR 5 OR 6 LUBRICATION.
2. STUFFY BOX EVOL. SHOULD BE GREASED ONCE EVERY SIX MONTHS OR AFTER EVERY 200 WORKING HOURS.
3. STUFFY BOX EVOL. SHOULD BE REPLACED AT LEAST EVERY 4 YEARS OR AFTER EVERY 500 WORKING HOURS.

STUFFY GREASE* 25 ML

SPECIAL CORROSION CONTROL GREASE. WATER RESISTANT FORMULA. LONG LASTING LUBRICATING GREASE. PROTECTS RUBBER PARTS THAT ARE SUBJECT TO LONG FRICTIONS. TEMPERATURES:-15+125° DO NOT DISPERSE IN THE ENVIRONMENT AFTER USAGE.